



## Configurar VPN do 2º CTA em um dispositivo Android

Instrução para configuração:

**1: Menu -> configurações/settings ->2: conexões/connections -> 3: Mais/more -> 4: VPN ->5:-> + -> 6: Edit/Editar VPN (nome pode ser qualquer um) -> 7: IPsec Xauth PSK -> 8: server name : vpn.2cta.eb.mil.br\_identificador iPsec: eb-rj ->9: Senha pré-compartilhada IPsec/IP-Sec pre-shared key:**

**(copie e cole no respectivo campo esta senha):  
Sdfste4tgE3535eteeydYeddr@#s4Gd5653**

**→ 10:username/Nome de usuário (o seu nome de usuário@2cta.eb.mil.br) e senha ->11: Salvar ->12: Connect/Conectar**

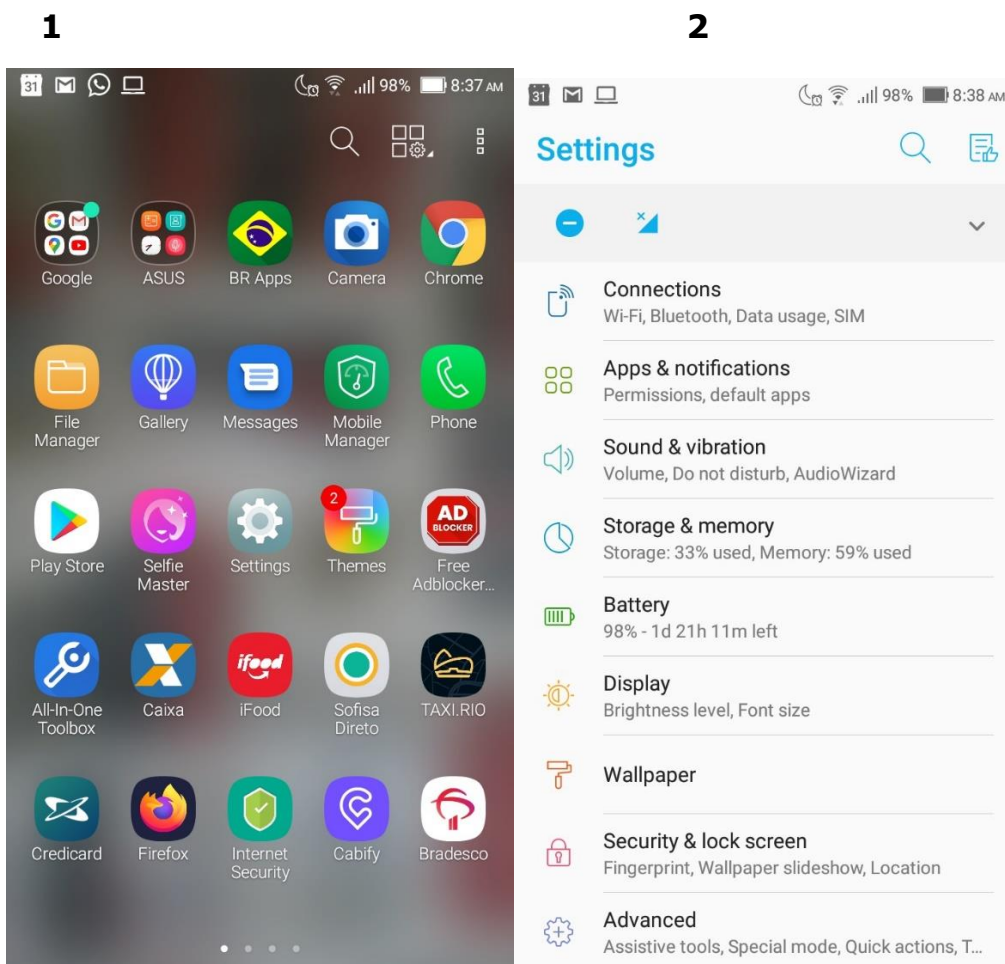

3

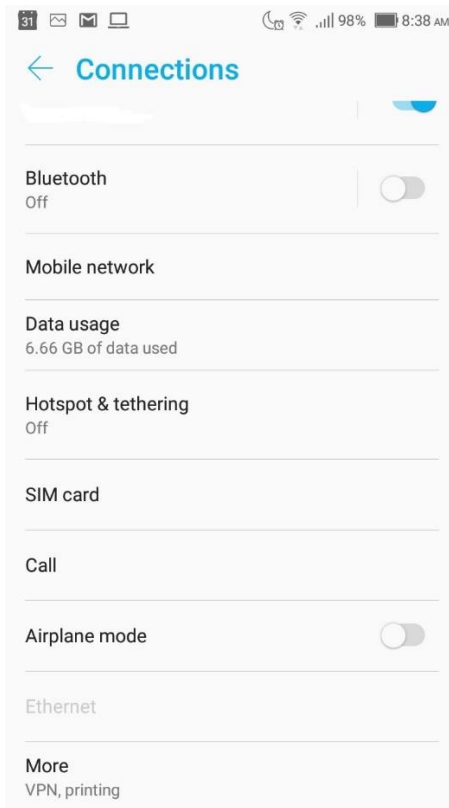

4

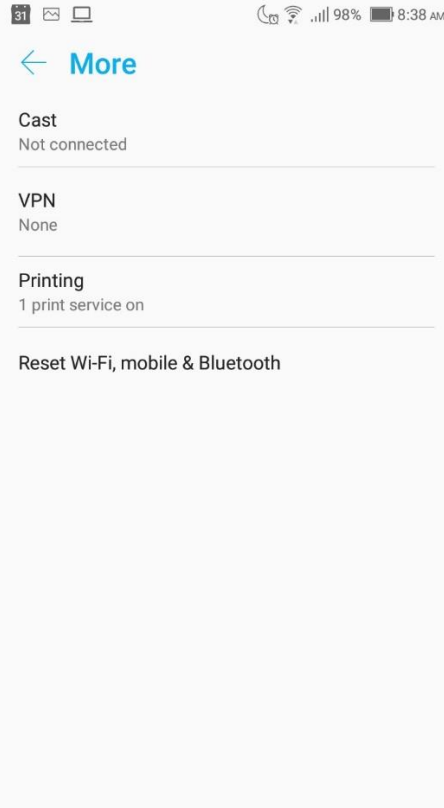

5

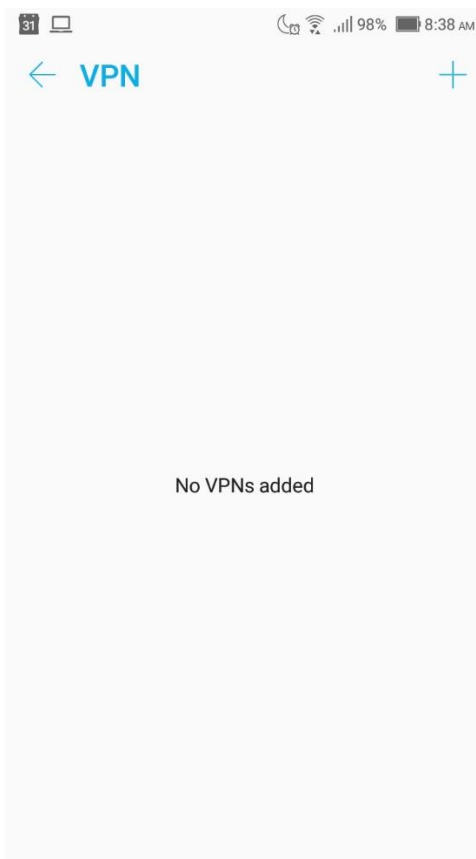

6

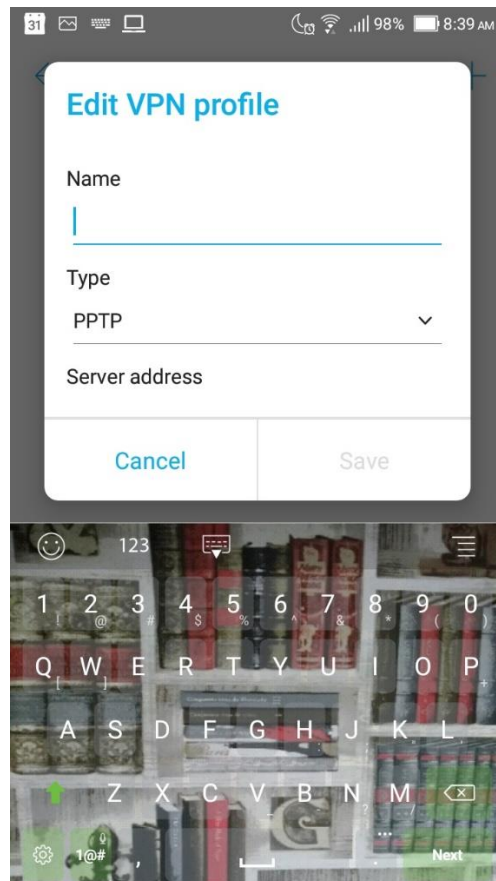

7

8

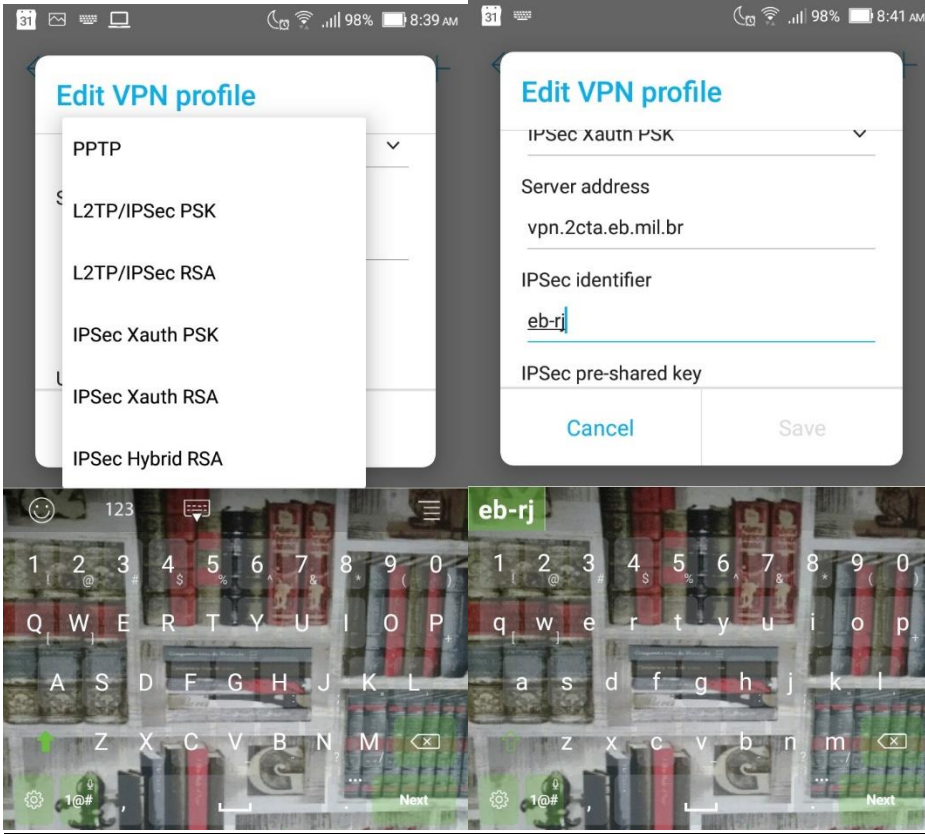

9

10

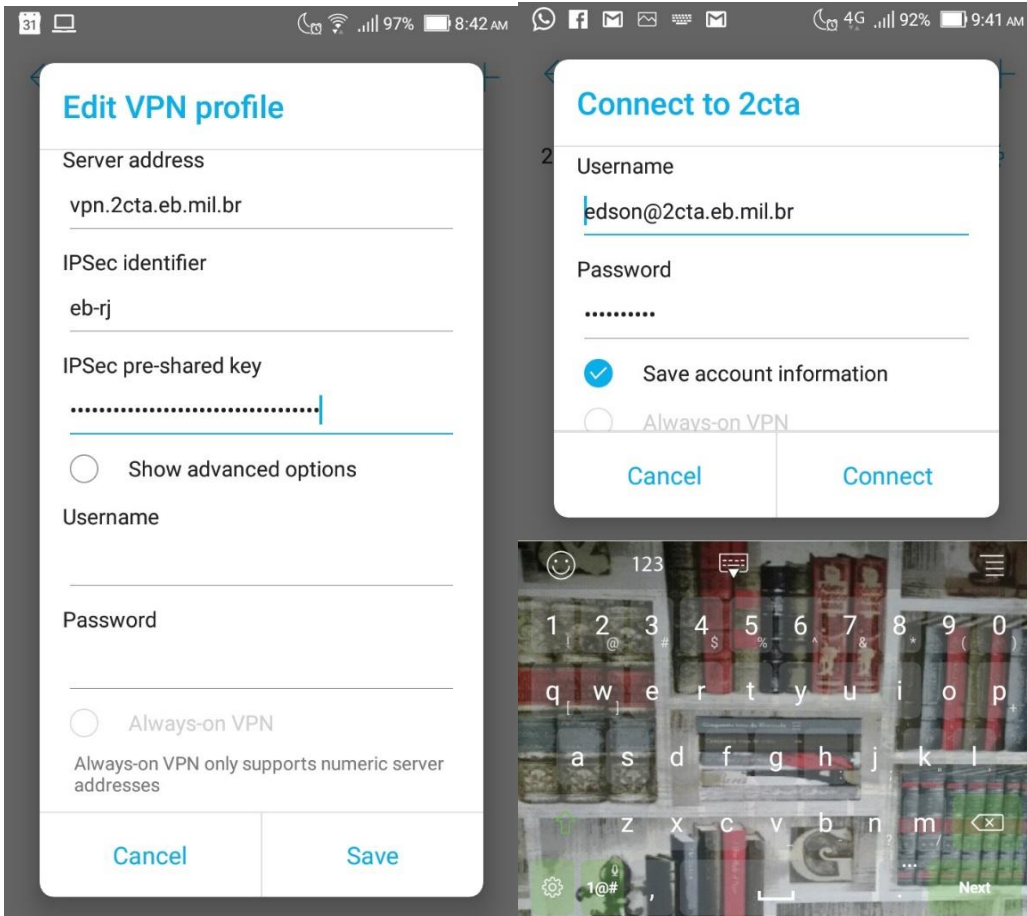

## Agora você está conectado a VPN do 2º CTA:

